

ELECTRIC CHARACTERISTICS

Nominal Voltage	0/250 V _{ac} - 50/60 Hz
Phase to phase test voltage	1450 V _{dc} (2 s)
Phase to ground test voltage	2150 V (2 s)
Climatic class	-25 / +85 °C



FIN33	Nominal current at 40°C (A)	C _x (μF)	L ₁ (mH)	C _y (nF)	Power loss (W)
.003.F	3	0,082	1,7	4,7	1,5
.006.F	6	0,082	1,7	4,7	2,1
.010.F	10	0,082	1,7	4,7	2,8
.020.F	20	0,2	0,8	4,7	3,8
.040.V	40	0,2	0,7	4,7	4,5
.050.V	50	0,2	0,6	4,7	5,5
.075.V	75	0,2	0,6	4,7	7
.100.V	100	0,2	0,4	4,7	10

Leakage current at 230 V phase to ground- 50 Hz / 40°C < 1mA

MECHANICAL DIMENSIONS (mm)

MODELLO Model	A	B	H	N	F	L	I	V	d	Weight Kg	Case
FIN33.003.F	27,6	45,5	72	—	5	60	51	14	6,5	0,13	1
FIN33.006.F	27,6	45,5	72	—	5	60	51	14	6,5	0,13	1
FIN33.010.F	27,6	45,5	72	—	5	60	51	14	6,5	0,2	1
FIN33.020.F	39	51,8	84	—	5	74	65	15	6,5	0,18	2
FIN33.040.V	40	86,6	107	96	6X4	50/55	100	20	M5	0,18	3
FIN33.050.V	50	100	125	115	6X4	120	180	50	M8	0,30	3
FIN33.075.V	50	100	125	115	6X4	120	180	50	M8	0,30	3
FIN33.100.V	70	120	150	135	6X4	120	180	50	M8	0,30	3

CASE 1

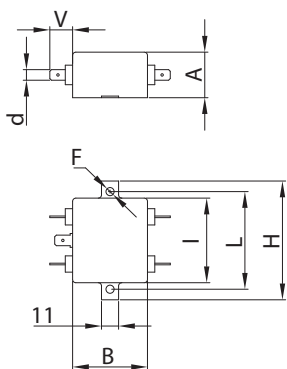

CASE 2

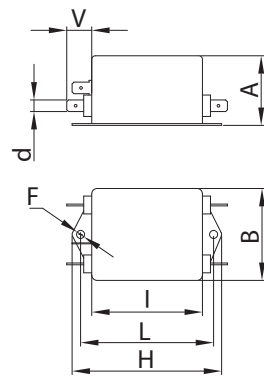

CASE 3

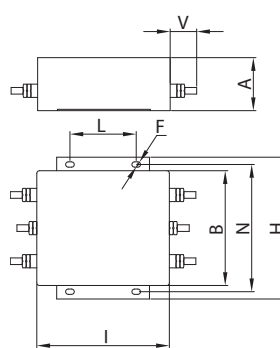

CASE 1 ASSEMBLING

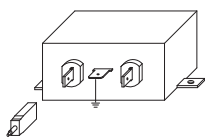

CASE 2 ASSEMBLING

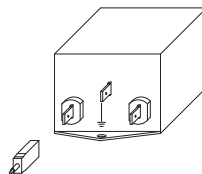

CASE 3 ASSEMBLING

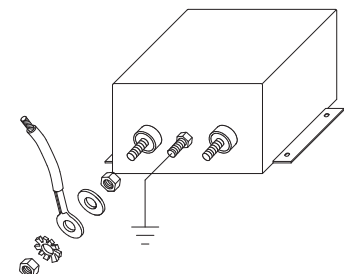

ELECTRIC DIAGRAM

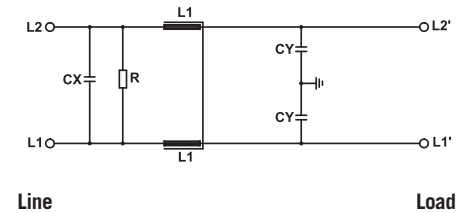

COMMON MODE ATTENUATION

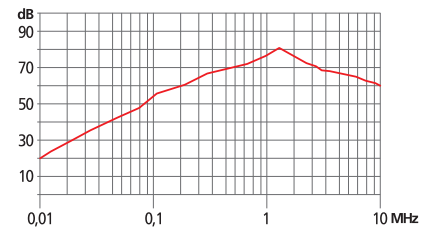

DIFFERENTIAL MODE ATTENUATION

