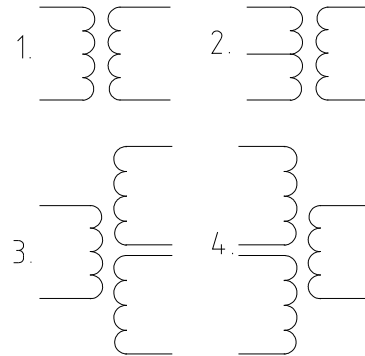

**ELECTRIC CHARACTERISTICS**

Rated frequency	50/60 Hz
Electric strength	4 kV
Insulation class	B
Max. ambient temperature	70 °C

**ELECTRIC DIAGRAM**

<b>EI 38</b>	Max. output power (VA)	PRI (V)	SEC (V)	Short circuit protection
-02/...	2,35	24-230	3-35	Inherently short circuit proof
-12/...	3,3	24-400	3-170	Inherently short circuit proof
-13/...	3,3	24-660	3-240	Inherently short circuit proof
-12F/...	4,5	24-440	3-60	Non-inherently short circuit proof
-13F/...	4,5	120-240	3-24	Non-inherently short circuit proof
-12G/...	4,5	100-240	3-24	Not short circuit proof
-22F/...	6	100-400	3-24	Non-inherently short circuit proof

Approved to EN 61558  
Safety class II.

**MECHANICAL DIMENSIONS (mm)**

<b>EI 38</b>	A	B	C	D	E	H	L	Weight (g)	Case
-02/...	40,6	34,9	-	-	-	22,1	25	102	O
-12/...	40,6	34,9	-	-	-	28,1	25	150	O
-13/...	40,6	34,9	47,5	3,2	55,6	28,1	25	150	K
-22/...	41	34,9	-	-	-	32	25	173	O

**CONNECTION**

Solder pins Ø 0,8 mm

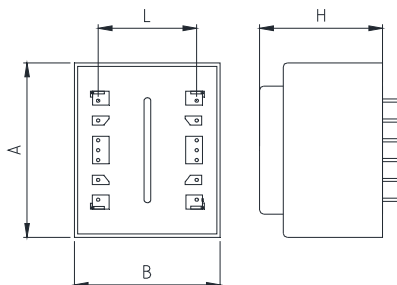
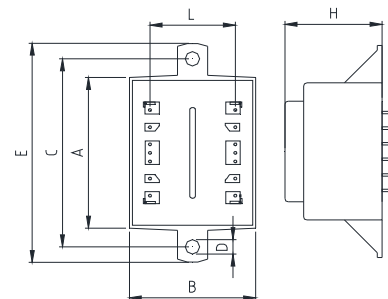
**CASE "O"**

**CASE "K"**

Further versions, prim. or sec. voltages, pin configurations on request.