



Single-phase safety transformers 0.35 to 100 VA

Datasheet 202303

APPROVALS

CHARACTERISTICS

- Rated power from 0.35 to 100 VA
- Available with various connections
- Available with integrated fuse

BENEFITS

- Vacuum resin coating
- Available with series or parallel voltage

MARKETS

- Electronic devices
- Home appliances
- Electronic boards

POWER VA

2	30	60	90	120	180
---	----	----	----	-----	-----

CODE

EI	30	03	13	21	A	4	100	5	10
LAMINATED TYPE	LAMINATED DIMENSION (mm)	WITHOUT ASSEMBLY "0"	WITH ASSEMBLY "K"	VERTICAL VERSION	FUSE PROTECTION	MAX AMBIENT TEMPERATURE	INTERNAL CODE	SECONDARY VOLTAGE	PRIMARY VOLTAGE
EE	20	01	13	21	A = external secondary E = primary external G = external F = temperature sensor T = temperature switch	40C = 4 70C = 7		6V = 0	115V = 10
EI	30	02	33	31				9V = 1	230V = 12
UI	38	03	35	41		12V = 2		240V = 04	
	42	12				15V = 3			
	48	32				18V = 4			
	54	34				24V = 5			
	60	X6							
	66	X10							
	84	Y7							
		Y8							
		Y9							
		Y10							

TECHNICAL SPECIFICATIONS

Primary voltage	0 - 690 Vac
Secondary voltage	0 - 690 Vac
Power	0.35 - 100 VA
Insulation class	B
Temperature class	-20° C to +80° C
Winding	Copper
Service	Continuous
Derating	-20° C to +80° C
Altitude derating	1500m, over 1% decrease every 100m
Wrapped IP protection	IP20
Connection protection	IP00 with pins IP20 with cable
Frequency	50/60 Hz
Dielectric strength	4 KV

MECHANICAL DIMENSIONS mm

Model	Power (VA)		External Dimensions (mm)				Weight (Kg)	Case
	Min	Max	A	B	H			
					Min	Max		
EI30***	0.35	4.8	32.3	27.3	16.5	33.8	0.140	1,2
EI38***	2	6	40.6	34.9	22.1	32	0.173	1,2
EI42***	4	8.6	43.8	36.8	32.3	38	0.255	1,2,3
EI48***	7	14	51.2	43	37.8	38.5	0.335	1,2,3
EI54***	7	20.5	57.6	48.6	41.7	43.2	0.500	1,2,3
EI60***	20	30	63.6	53.6	47.5	57.3	0.806	1,2,3
EI66***	15	50	69.6	58.6	48.5	61	0.950	1,2,3
EI84***	85	100	93.5	75.5	63.8	76.5	64	2,3

*** Product code name

Transformer measurements in the table are intended for Case 1

Contact Enerdoor for Case 2 and Case 3 dimensions

CASE 1

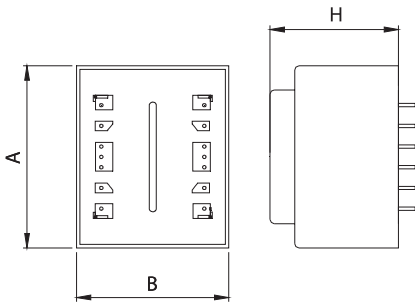

CASE 2

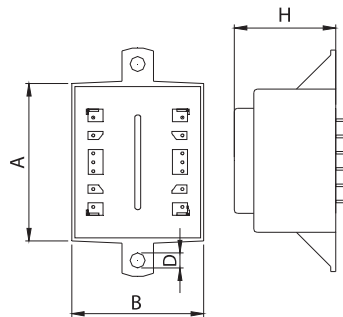

CASE 3

